

DESIGN: **PAOLO BISTACCHI**  
Elettra







# Elettra

Int. Reg. (1995)

Gamma di apparecchi a luce diffusa per lampade fluorescenti elettroniche, ad incandescenza e alogene per attacco singolo. Struttura in metallo, disponibile in nickel satinato e cromo. Diffusore in policarbonato nei colori: bianco, albicocca o sabbia. Segno caratteristico della gamma è un'esile spirale metallica che unisce il diffusore alla struttura metallica portante. La gamma comprende: Lampade da terra, da tavolo, o a parete.

Range of luminaires for diffused light that take screw socket electronic compact fluorescent, incandescent or halogen bulbs. Housing in metal, available in brushed steel and chrome. Polycarbonate diffuser in white, apricot and sand. A distinctive feature in the design of this range is the light metal spiral used to fit the diffuser to the luminaire's metal frame. The range comprises floor, table and wall lamps.

Eine Serie für diffuses Licht mit der Möglichkeit, einseitig gesockelte Kompaktleuchtstofflampen, Sockel E27 mit integriertem Vorschaltgerät oder für normale Allgebrauchslampen sowie für Halogenglühlampen E27 einzusetzen. Das Metallgestell ist in edelstahl matt oder chrom erhältlich. Die Schirme, die mit einer Metallspirale gehalten werden, sind in den Farben Weiß, Aprikot oder Sand erhältlich. Die Serie besteht aus Steh-, Tisch- und Wandleuchten.

Série d'appareils avec lumière diffuse pour lampes fluorescentes électroniques, incandescentes et halogène pour simple attache. Structure en métal, disponible dans les finitions nickel satiné et chrome. Diffuseur en polycarbonate disponible dans les couleurs: blanc, abricot ou sable. Le signe caractéristique de la série est une mince spirale métallique qui unit le diffuseur à la structure métallique portante. La série est composée pour: lampadaire, lampe de table, ou applique.

Серия светильников рассеянного света для флюорисцентных элекронных ламп накаливания и аллогенных для сингулярного присоединения. Каркас из металла, рассеиватель из поликарбоната разных цветов: белый, персиковый и песочный. Характеристическая особенность серии – спиральный металлический гексил, который соединяет рассеиватель с несущей металлической структурой. В серию входят: напольные, настольные и настенные светильники.



1.



2.

**1.** Particolare della struttura portante della lampada e della spirale metallica caratteristica dell'apparecchio.

View of the main luminaire structure and the distinctive side metal spiral.

Ansicht auf die Leuchte mit seinem Schirm und derer seitlich angebrachten Spiralen.

Détail de la structure en métal et de la spirale métallique caractéristique de l'appareil.

Вид несущей структуры светильника и его металлической спирали, показанной сбоку.

**2.** Dettaglio del cilindro in metallo collegato all'interruttore di accensione.

Detail of the metal cylinder connected to the switch.

Detailansicht der Fassung und dem dort untergebrachtem Schalter.

Détail du cylindre en métal solidaire de l'interrupteur.

Металлическая деталь цилиндра соединена с выключателем.

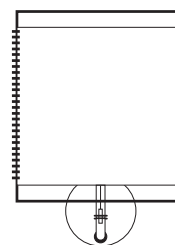
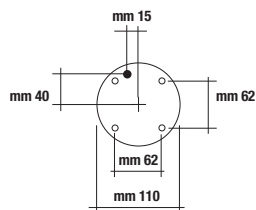

(Elettra 30 W) mm 300 (11<sup>3</sup>/<sub>4</sub>)  
(Elettra 22 W) mm 220 (8<sup>3</sup>/<sub>4</sub>)

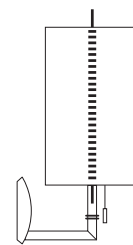

mm 220 (8<sup>3</sup>/<sub>4</sub>)  
mm 160 (6<sup>1</sup>/<sub>4</sub>)

(Elettra 30 W) mm 420 (16<sup>1</sup>/<sub>2</sub>)  
(Elettra 22 W) mm 350 (13<sup>3</sup>/<sub>4</sub>)

## Elettra 30 W

				Colore/Finish Ausführung Couleurs/Laer	
1x150W A60/QT32	<input type="checkbox"/>		<b>2245DB.</b>	<b>01</b>	<b>02</b>
1x150W A60/QT32	<input type="checkbox"/>		<b>2245DS.</b>	<b>01</b>	<b>02</b>
1x150W A60/QT32	<input checked="" type="checkbox"/>		<b>2245DA.</b>	<b>01</b>	<b>02</b>

## 1x150W E27



## Elettra 22 W

				Colore/Finish Ausführung Couleurs/Laer	
1x100W A60/QT32	<input type="checkbox"/>		<b>2246DB.</b>	<b>01</b>	<b>02</b>
1x100W A60/QT32	<input type="checkbox"/>		<b>2246DS.</b>	<b>01</b>	<b>02</b>
1x100W A60/QT32	<input checked="" type="checkbox"/>		<b>2246DA.</b>	<b>01</b>	<b>02</b>

## 1x100W E27



- Diffusore bianco - White diffuser - Schirm Weiß - Diffuseur blanc - Белый отражатель
- Diffusore sabbia - Sand diffuser - Schirm Sand - Diffuseur sable - Отражатель песочного цв
- Diffusore albicocca - Apricot diffuser - Schirm Aprikot - Diffuseur abricot - Отражатель персикового цв



(Elettra 40 T) mm 400 (15"3/4)  
 (Elettra 30 T) mm 300 (11"3/4)  
 (Elettra 22 T) mm 220(8"3/4)

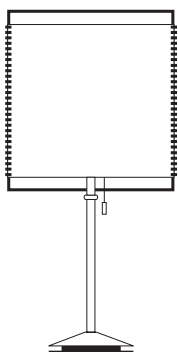

(Elettra 40 T) mm 770 (30"1/4)  
 (Elettra 30 T) mm 630 (24"3/4)  
 (Elettra 22 T) mm 480 (19")

## Elettra 40 T

			Colore/Finish Ausführung Couleurs/L'èet		
1x200W / 1x250W A60/QT32	<input type="checkbox"/>		2.9	<b>2250DB.</b>	01 02
1x200W / 1x250W A60/QT32	<input type="checkbox"/>		2.9	<b>2250DS.</b>	01 02
1x200W / 1x250W A60/QT32	<input checked="" type="checkbox"/>		2.9	<b>2250DA.</b>	01 02
1x200W / 1x250W A60/QT32	<input type="checkbox"/> D		2.9	<b>B112DB.</b>	01 02
1x200W / 1x250W A60/QT32	<input type="checkbox"/> D		2.9	<b>B112DS.</b>	01 02
1x200W / 1x250W A60/QT32	<input checked="" type="checkbox"/> D		2.9	<b>B112DA.</b>	01 02

### 1x200W E27



### 1x250W E27



## Elettra 30 T

			Colore/Finish Ausführung Couleurs/L'èet		
1x150W A60/QT32	<input type="checkbox"/>		2.2	<b>2251DB.</b>	01 02
1x150W A60/QT32	<input type="checkbox"/>		2.2	<b>2251DS.</b>	01 02
1x150W A60/QT32	<input checked="" type="checkbox"/>		2.2	<b>2251DA.</b>	01 02
1x150W A60/QT32	<input type="checkbox"/> D		2.2	<b>A949DB.</b>	01 02
1x150W A60/QT32	<input type="checkbox"/> D		2.2	<b>A949DS.</b>	01 02
1x150W A60/QT32	<input checked="" type="checkbox"/> D		2.2	<b>A949DA.</b>	01 02

### 1x150W E27

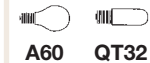

## Elettra 22 T

			Colore/Finish Ausführung Couleurs/L'èet		
1x100W A60/QT32	<input type="checkbox"/>		1.6	<b>2252DB.</b>	01 02
1x100W A60/QT32	<input type="checkbox"/>		1.6	<b>2252DS.</b>	01 02
1x100W A60/QT32	<input checked="" type="checkbox"/>		1.6	<b>2252DA.</b>	01 02
1x100W A60/QT32	<input type="checkbox"/> D		1.6	<b>A951DB.</b>	01 02
1x100W A60/QT32	<input type="checkbox"/> D		1.6	<b>A951DS.</b>	01 02
1x100W A60/QT32	<input checked="" type="checkbox"/> D		1.6	<b>A951DA.</b>	01 02

### 1x100W E27

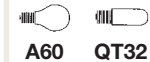

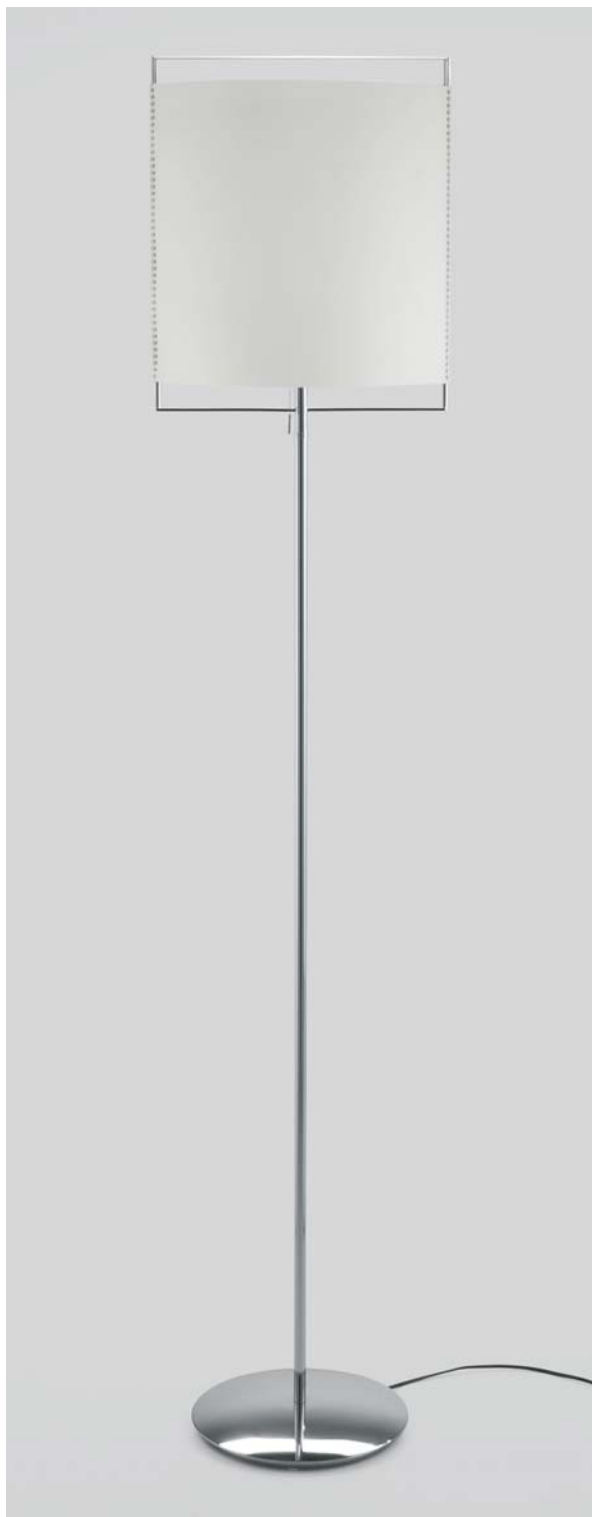

(Elettra 40 F) mm 400 (15"3/4)  
(Elettra 30 F) mm 300 (11"3/4)

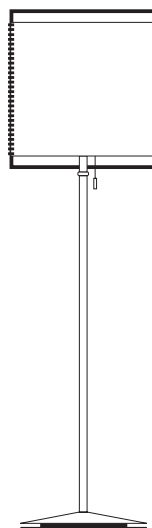

(Elettra 40 F) mm 1840 (72"1/2)  
(Elettra 30 F) mm 1600 (63")

Elettra 40 F				Colore/Finish Ausführung Couleurs/L'èter		1x200W E27
1x200W / 1x250W A60/QT32	<input type="checkbox"/>		<b>2253DB.</b>	<b>01</b>	<b>02</b>	
1x200W / 1x250W A60/QT32	<input type="checkbox"/>		<b>2253DS.</b>	<b>01</b>	<b>02</b>	<b>A60</b>
1x200W / 1x250W A60/QT32	<input checked="" type="checkbox"/>		<b>2253DA.</b>	<b>01</b>	<b>02</b>	
1x200W / 1x250W A60/QT32	<input type="checkbox"/> <b>D</b>		<b>A953DB.</b>	<b>01</b>	<b>02</b>	1x250W E27
1x200W / 1x250W A60/QT32	<input type="checkbox"/> <b>D</b>		<b>A953DS.</b>	<b>01</b>	<b>02</b>	
1x200W / 1x250W A60/QT32	<input checked="" type="checkbox"/> <b>D</b>		<b>A953DA.</b>	<b>01</b>	<b>02</b>	<b>QT32</b>

Elettra 30 F				Colore/Finish Ausführung Couleurs/L'èter		1x150W E27
1x150W A60/QT32	<input type="checkbox"/>		<b>2254DB.</b>	<b>01</b>	<b>02</b>	
1x150W A60/QT32	<input type="checkbox"/>		<b>2254DS.</b>	<b>01</b>	<b>02</b>	<b>A60 QT32</b>
1x150W A60/QT32	<input checked="" type="checkbox"/>		<b>2254DA.</b>	<b>01</b>	<b>02</b>	
1x150W A60/QT32	<input type="checkbox"/> <b>D</b>		<b>A955DB.</b>	<b>01</b>	<b>02</b>	
1x150W A60/QT32	<input type="checkbox"/> <b>D</b>		<b>A955DS.</b>	<b>01</b>	<b>02</b>	
1x150W A60/QT32	<input checked="" type="checkbox"/> <b>D</b>		<b>A955DA.</b>	<b>01</b>	<b>02</b>	